

**ROOF VENTILATION**

ENSURE EAVES VENTILATION PROVIDED EQUIVALENT TO 10mm CONTINUOUS GAP FULL LENGTH OF EAVES.FOR DORMER ROOF CONSTRUCTION SEE NOTES OPPOSITE

**NEW PARTITIONING**

100mm x 50mm STUDS @ 400mm CENTRES,100mm x 75mm HEAD AND SOLE PLATES WITH MATCHING NOGGINS @600mm STAGGERED CENTRES. 12.5mm PLASTERBOARD EITHER SIDE AND FILL 100mm 90kg /cu.m. ROCKWOOL SOUND INSULATION. FINISH UNDER STAIRCASE WITH SOUND INSULATION & 12.5mm PLASTERBOARD ON SOFTWOOD NOGGINS.

**CEILINGS**

UNLESS OTHERWISE STATED ALL NEW CEILINGS TO BE FINISHED WITH 12.5mm THICK PLASTERBOARD TO UNDERSIDE OF JOISTS.JOINTS ARE TO BE TAPED & FINISHED WITH A SKIM COAT OF PLASTER ONE MIST AND TWO FULL COATS OF EMULSION.

**STEEL FIRE PROTECTION**

ENSURE THAT ALL STEEL BEAMS HAVE A MIN. 2 No. SHEETS 12.5mm STAGGER JOINTED PLASTERBOARD ON EML AND SOFTWOOD NOGGINS FOR 1hr FIRE PROTECTION.

**CEILING INSULATION**

LAY 150mm CROWN WOOL BETWEEN JOISTS AND CROSS-LAY 100mm CROWN WOOL OVER CEILING JOISTS. ENSURE 50mm AIR GAP ABOVE SLOPING SOFFIT EITHER SIDE REMAINS CLEAR USING PROPRIETARY EAVES VENTILATION PANEL.

**ELECTRICAL INSTALATION**

ALL ELECTRICAL WORK REQUIRED IS TO BE IN ACCORDANCE WITH PART P OF THE APPROVED DOCUMENTS.ELECTRICAL SAFETY MUST BE DESIGNED, INSTALLED,INSPECTED AND TESTED BE A PERSON QUALAIFIED TO DO SO. PRIOR TO COMPLETION THE LOCAL AUTHORITY MUST BE SATISFIED THAT ANY SUCH WORK (OTHER THAN MINOR WORKS) COMPLIES WITH PART P. THIS WILL REQUIRE AN APPROPRIATE BS 7671 CERTIFICATE TO BE ISSUED FOR THE WORK BY A PERSON AUTHORISED TO DO SO.(IE.A PERSON WHO IS REGISTERED UNDER A RECOGNISED COMPETENT PERSONS SCHEME FOR SELF CERTIFICATION).

**WINDOWS**

WINDOWS TO HAVE OPENING PORTION EQUAL TO AT LEAST 1/20th FLOOR AREA OF THE ROOM.WINDOWS AND EXTERNAL DOORS SHOWN WITH MIN 20mm SEALED DOUBLE GLAZED UNITS,WITH PILKINGTONS 'K' GLASS INNER PANE.PROVIDE THERMABATE CAVITY CLOSERS AT PERIMETERS.EXTERNAL DOORS TO BE FITTED IN HIGH PERFORMANCE FRAMES.ALL OPENING LIGHTS & EXTERNAL DOORS TO BE FITTED WITH DRAUGHT SEALS AND ALL DOORS / WINDOW FRAMES TO BE SEALED AROUND THE BRICK OPENINGS TO LIMIT DRAUGHT INFILTRATION.PROVIDE VERTICAL AND HORIZONTAL DPC'S. WINDOWS,FRENCH OR PATIO DOORS TO BE FITTED WITH CONTROLLABLE AND SECURE TRICKLE VENTILATORS TO PROVIDE THE FOLLOWING CLEAR AREAS; KITCHEN /UTILITY /BATHROOMS /WC : 4000 sq mm ( 1 HEADLINE VENT ) IOUNGE /DINING /STUDY /BEDROOMS : 8000 sq mm ( 2 HEADLINE VENTS ). PROVIDE 6.4mm TOUGHENED GLASS TO BS 6206 OR OTHER GLAZING IN ACCORDANCE WITH PART N.OF THE BUILDING REGULATIONS IN ALL DOORS AND FRENCH DOORS WITH PANES GREATER THAN 250mm WIDE AND FOR ANY WINDOWS WITHIN 300mm OF A DOOR OR 800mm OFF A FLOOR. CLEAR ESCAPE AREA OF 800 x 500mm TO BE PROVIDED TO ALL NEW WINDOWS. PATIO DOORS TO HAVE HIT OR MISS NIGHT VENT WITH AN OPENABLE AREA OF AT LEAST 4000mm. REQUIRED U-VALUE 0.2 W /M DEG.C.

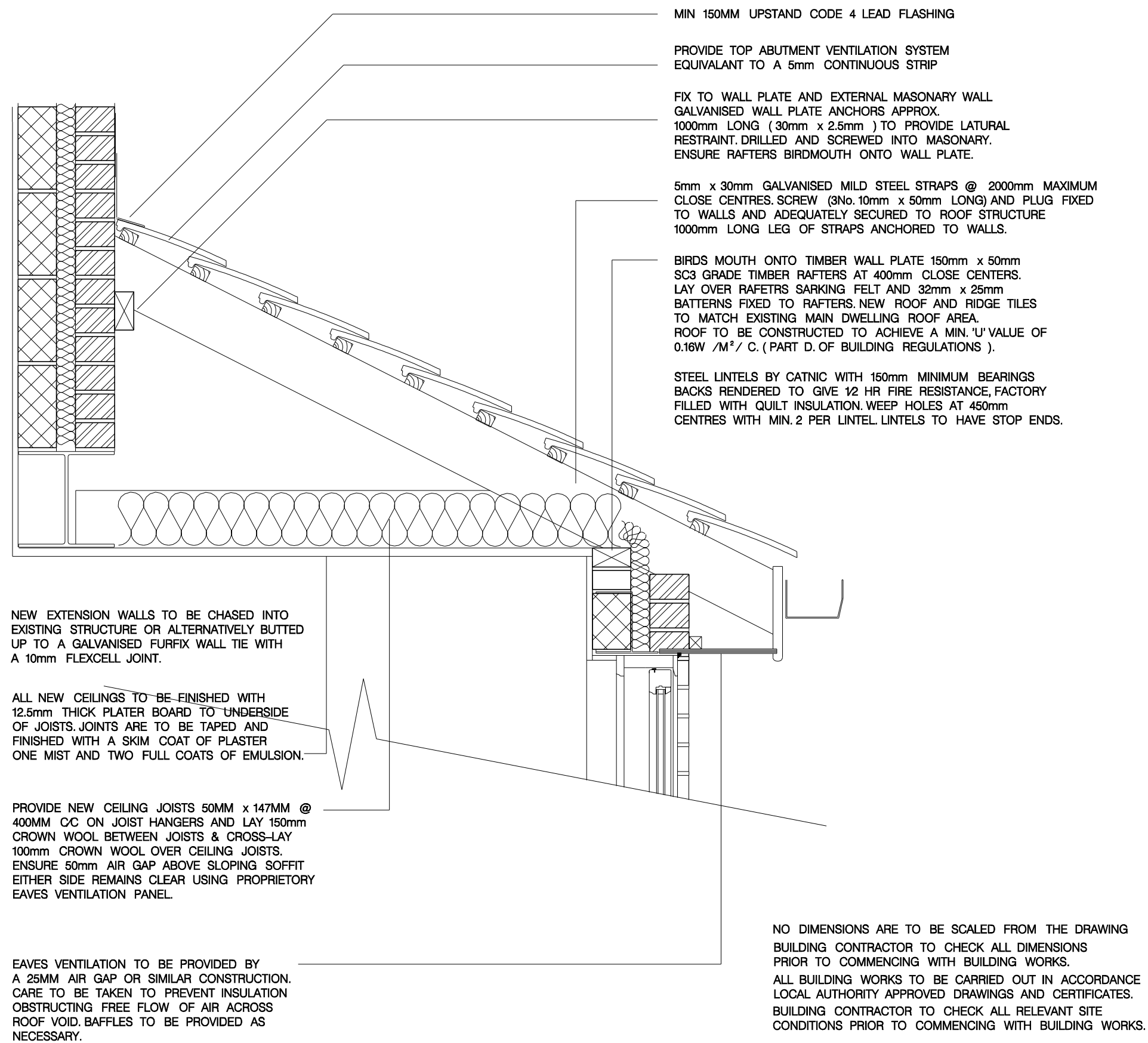

REVISIONS			CLIENT	SITE - LOCATION	PROJECT	ROOM-BY-ROOM (UK) LTD		
No.	DESCRIPTION	DATE	MR & MRS P	WARE HERTFORDSHIRE	TYPICAL ROOF SECTION	ARCHITECTURAL		
A.	DRAWING UPDATED IN ACCORDANCE WITH BUILDING CONTROL REQUIRMENTS.	03.02.06				t.01920-424280 m.07814-146779	14 HAZELDELL Watton-at-Stone Hertford Hertfordshire SG14 3EN	
					DATE	SCALE	DRAWING NO.	REV.
					DEC 2005	NTS	4005.05.04	A